

An architectural rendering of a modern transportation network. The scene shows a wide, multi-modal street with a dedicated car lane on the left, a central pedestrian and cyclist zone, and a green-paved area on the right. People are shown walking, pushing a stroller, and riding a bicycle. The street is lined with mature trees and colorful flower beds. In the background, more cars are visible on the road, and several birds are flying in a blue sky with light clouds.

Rossdale Transportation Network

CEA, March 11, 2024

Satya Gadidasu (City of Edmonton)

Dan Zeggelaar (ISL Engineering)

The logo for ISL Engineering, featuring the letters "ISL" in a white, italicized, sans-serif font on a dark blue square background.

ISL

The logo for the City of Edmonton, featuring the word "Edmonton" in a white, sans-serif font on a dark blue square background.

Edmonton

Outline

- Project Area
- History
- Project Direction
- Concept Design
- Next Steps

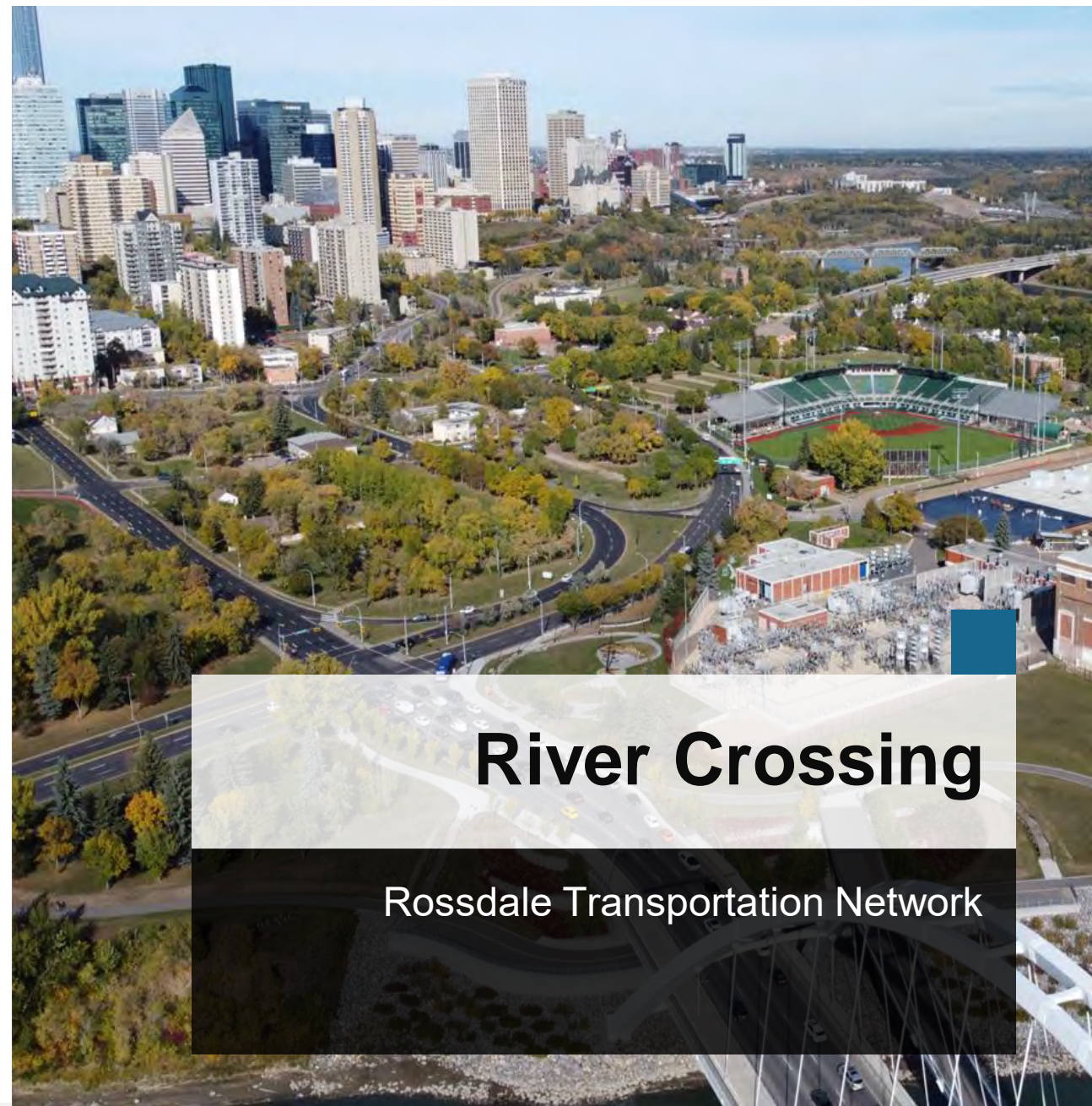

River Crossing

Rossdale Transportation Network

Project Location and Context

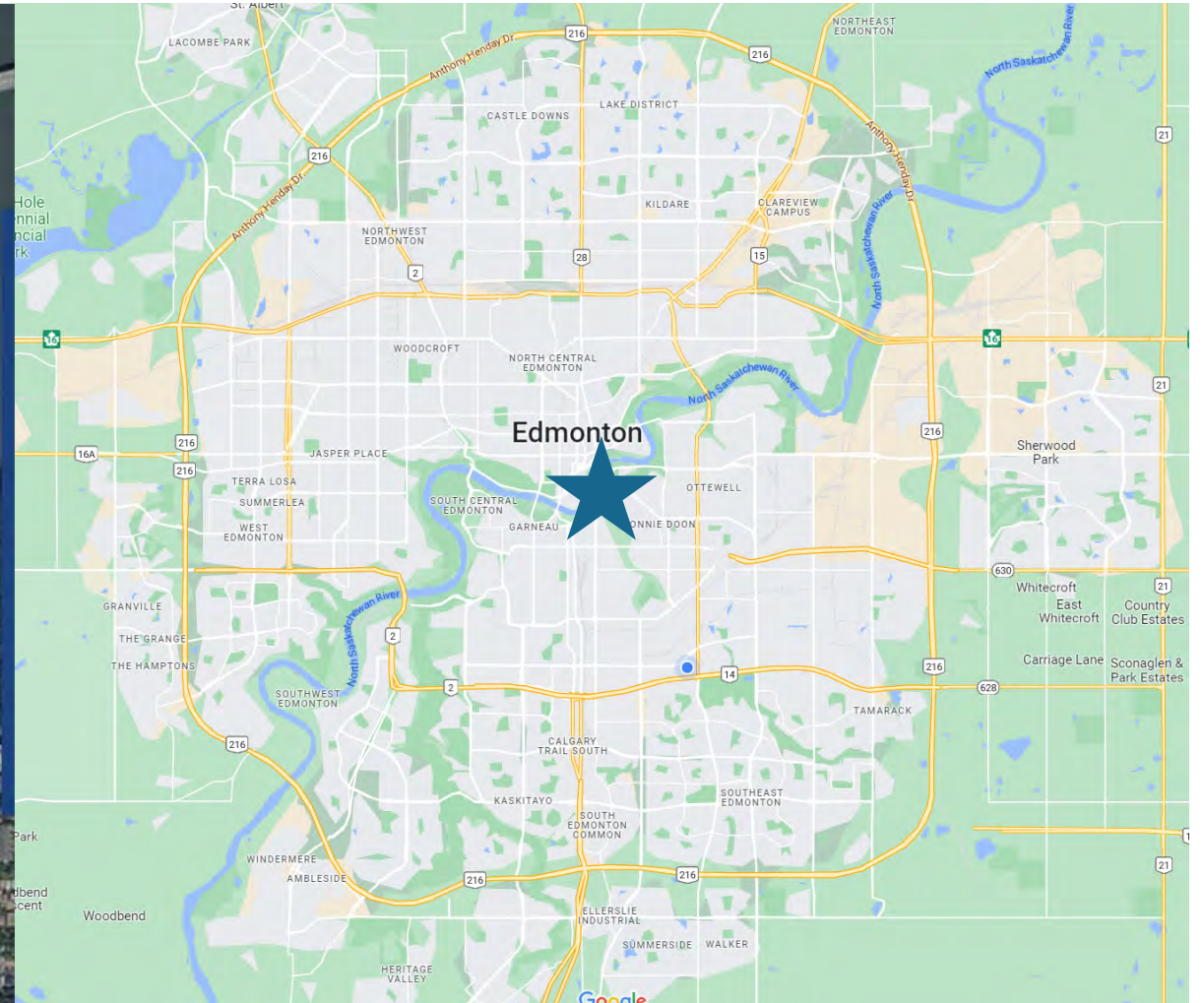

Existing Conditions



Existing Conditions



Existing Conditions



Existing Conditions



History

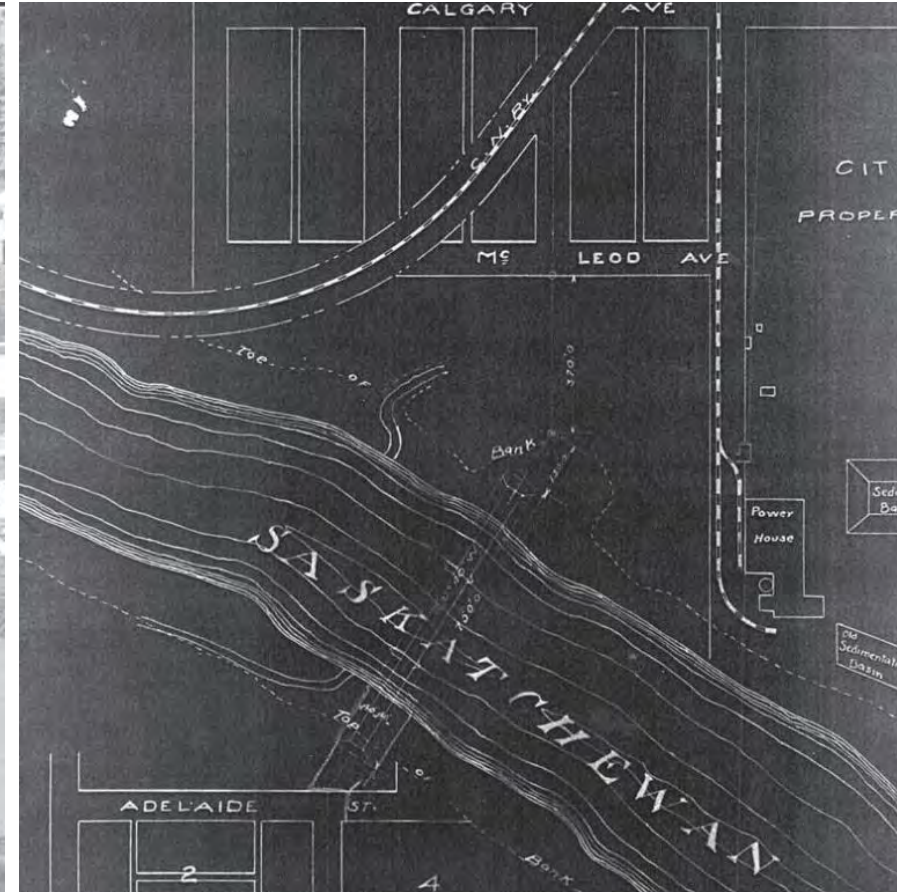
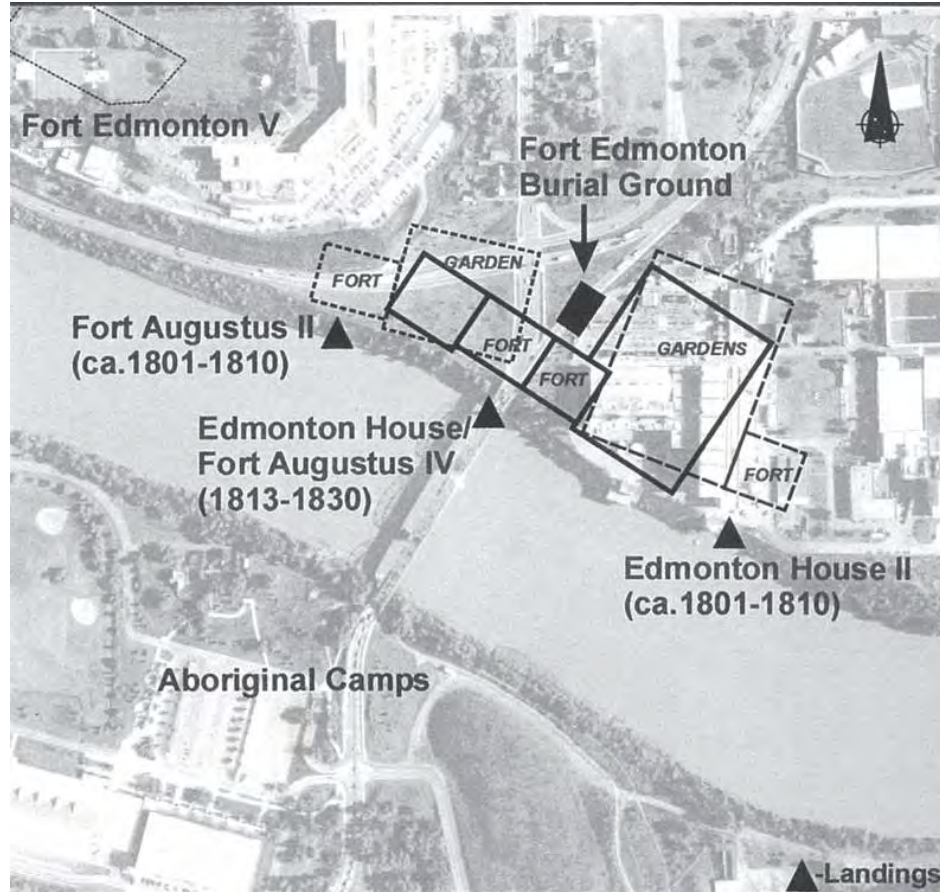

What used to be

1912

5th STREET BRIDGE
EDMONTON



What could have been



Timelines

1969 – METS plan (Freeway plan) – shot down in 1983

1986 – Rossdale Area Redevelopment Plan

2011 – West Rossdale Urban Design Plan approval

2015 - High-level **River Crossing** vision approved by City Council

2019 - **River Crossing Business Plan and Heritage Interpretive Plan** approved by City Council

2021 - Area Redevelopment Plan amendment

2021 - **Rossdale Transportation Network** planning and design begins

River Crossing Business Plan Vision



- The vision of the River Crossing Business Plan is to transform the central river valley into a vibrant community and special gathering space.
- The plan calls for an **interpretive park**, new residential developments, **Touch the Water Promenade** and a restoration of the **Rossdale Power Plant and Transportation needs** for future uses.

River Crossing Business Plan Direction



- Encouraging Active Transportation (Mode-Shift)
- Building Diverse Developments incl. Affordable Housing
- Encouraging New Business
- Preservation of Area's Natural/Cultural Heritage
- Promoting Sustainability and Environmental Responsibility

Rossdale Transportation Network

Phases

- Phase 1 - Network Study

Roadway Network Changes



Active Transportation Changes



Phase 1 - Network Study

	105 Street	Rossdale Road	96 Avenue	104 Street	102 Street	97 Avenue	Bellamy Hill Road
Function	Maintain function	Street oriented arterial	Street oriented collector	Street oriented collector	Street oriented local	Maintain function	Maintain function
Number of Lanes	Maintain	1 or 2	1	1	1	Maintain	Maintain
Left/right turn bays	Yes	Likely	Arterial only ?	Arterial only ?	Arterial only ?	Yes	Yes
Design Speeds	Existing	50 km/h (40?)	30 km/h	30 km/h	30 km/h	Existing	Existing
Signal Priority	Vehicles	Pedestrians				Vehicles	Vehicles
Private Access	Existing	Maybe	Yes	Yes	Yes	Existing	Reconfigured
Intersections	Maintain	Reconfigured	Maintain	Reconfigured	RI, RO, only	Reconfigured	Reconfigured
Transit	Yes	Yes	Not planned	Not planned	No	Yes	Yes
Truck Route	Yes	Potential NB	No	No	No	Yes	Yes
Bike lanes	No	Protected	Protected	Shared	Shared	No	No
Street Parking	No	Potential	Yes	Yes	Yes	No	No
Pedestrian Connections	Existing + SUP (east side)	Sidewalk (North) SUP (South)	As per standard	As per standard	As per standard	Existing	Reconfigured

Existing (Left) and Recommended Roadway Network (Right)



Existing (Left) and Recommended Sidewalk Network (Right)

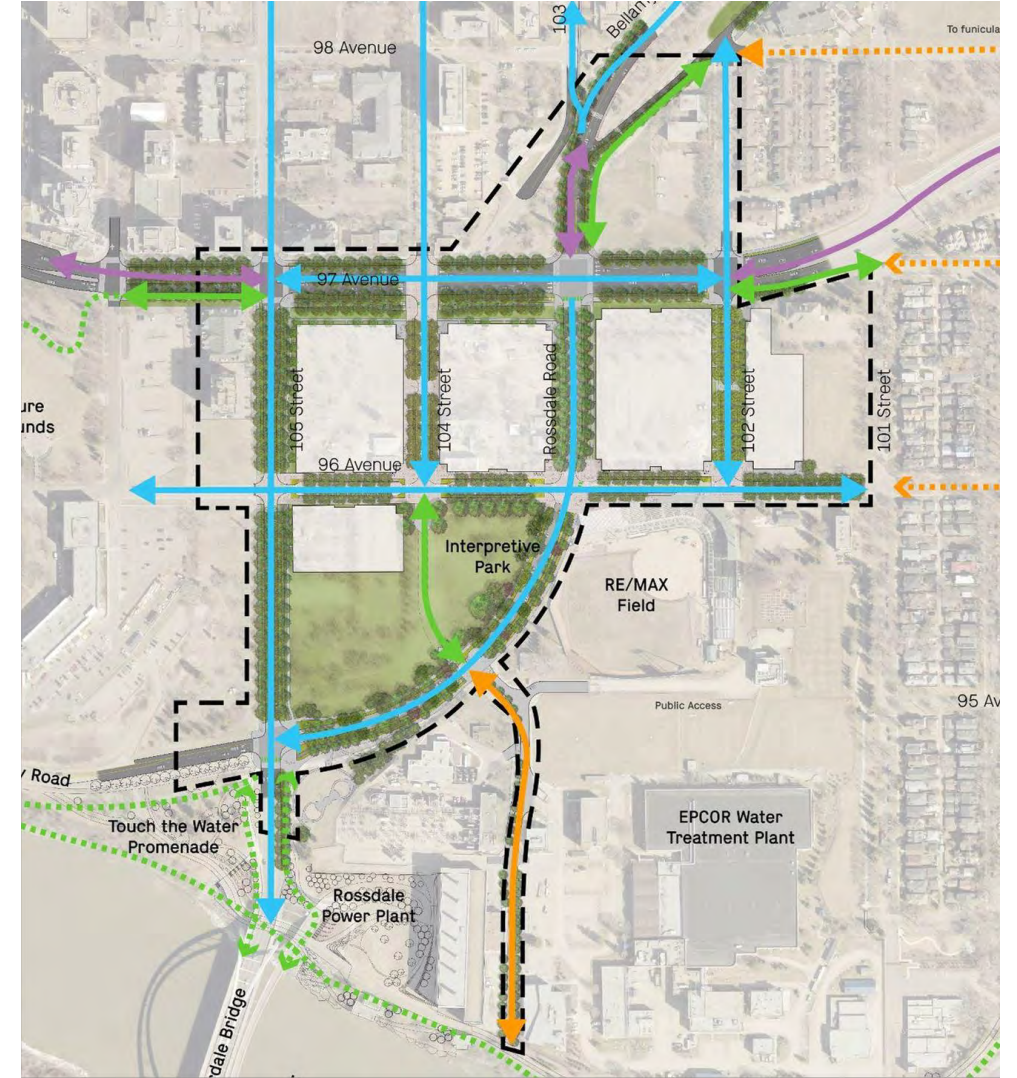

Existing (Left) and Recommended Cycling Network (Right)

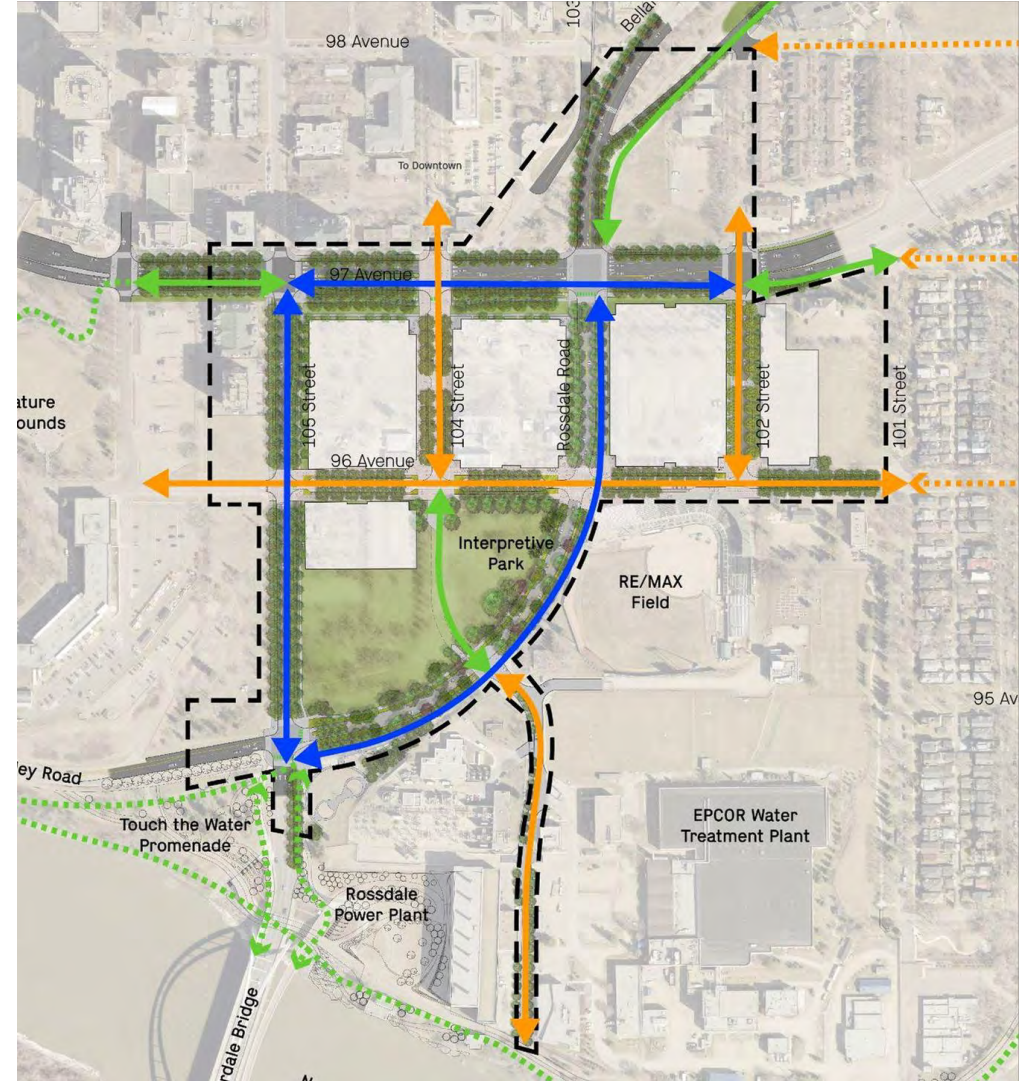

Phase 2 - Concept Planning

1. Transformation of Rosssdale Road into a parkway
2. Creation of a community heart
3. Creation of grand boulevards
4. Expanded neighbourhood connections
5. Enhanced connections into Downtown



Rossdale Transportation Network

Rossdale Road

1. Transformation of Rossdale Road into a parkway



Rossdale Transportation Network

Rossdale Road

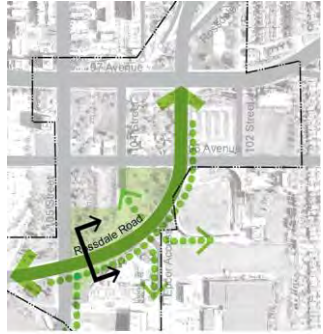

key plan



Rossdale Transportation Network

Rossdale Road



key plan

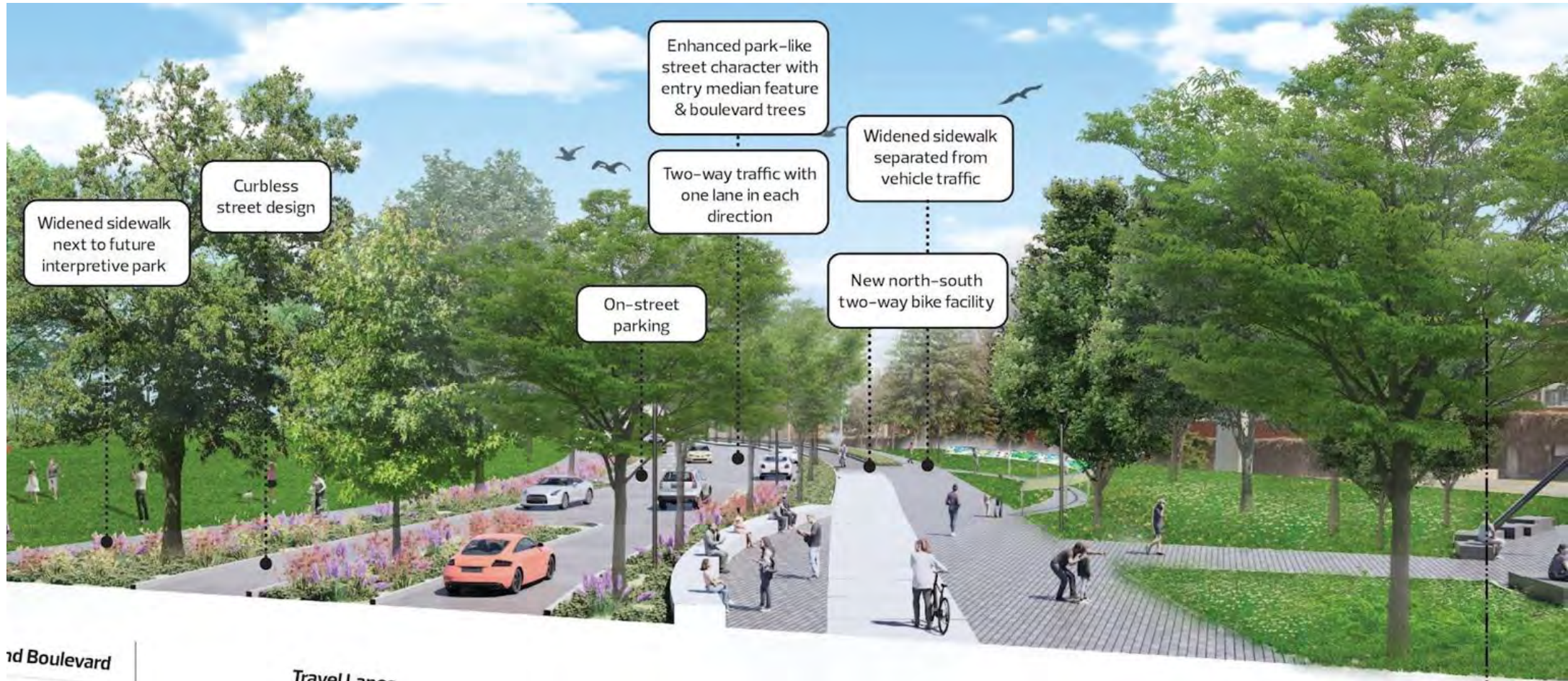

nd Boulevard

Travel Lane

Rossdale Transportation Network

Rossdale Road



key plan

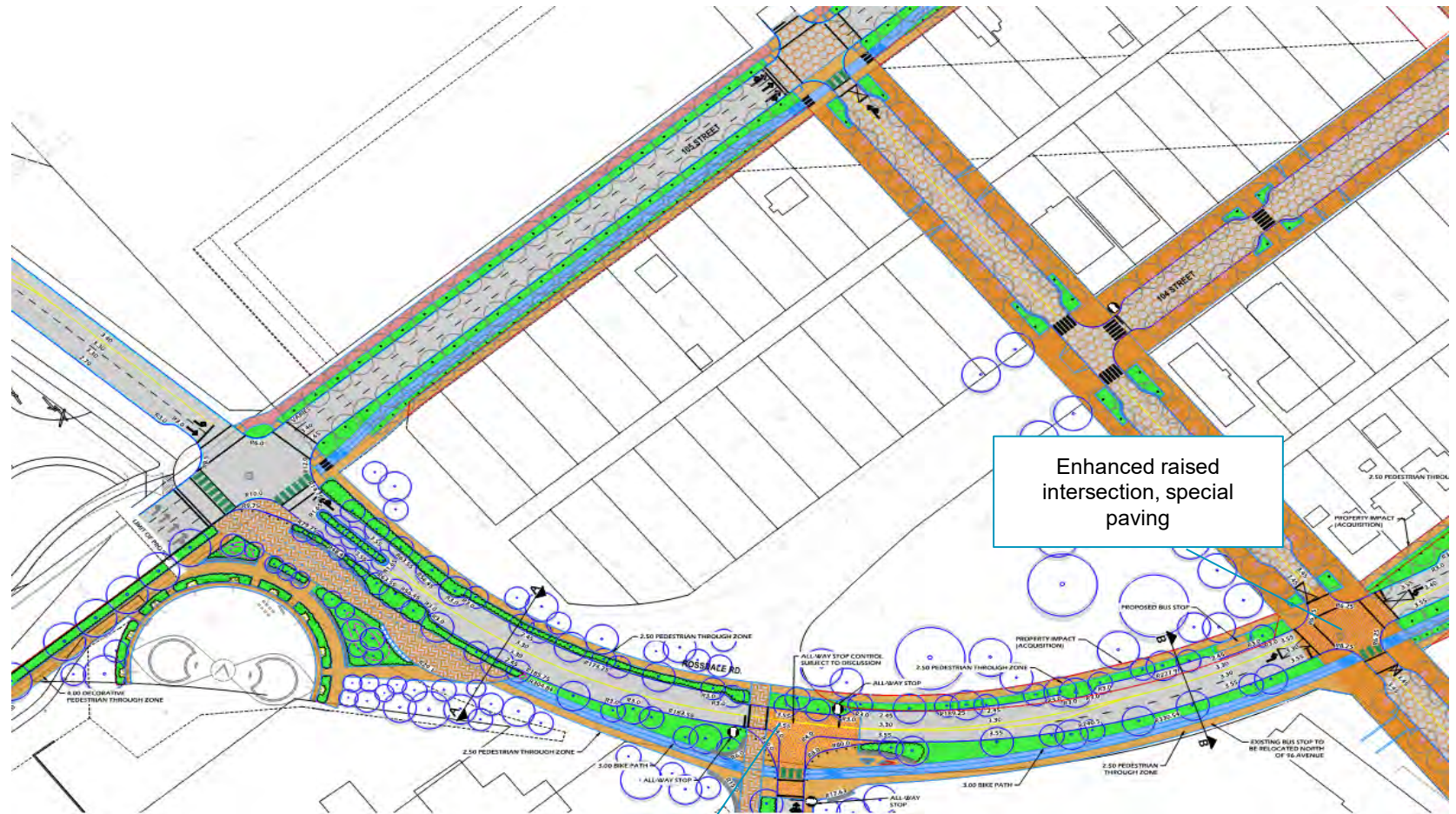

Enhanced raised intersection, special paving

Raised intersection, truck apron, delineation

Rossdale Transportation Network

96 Avenue and 104 Street

2. Create a community heart

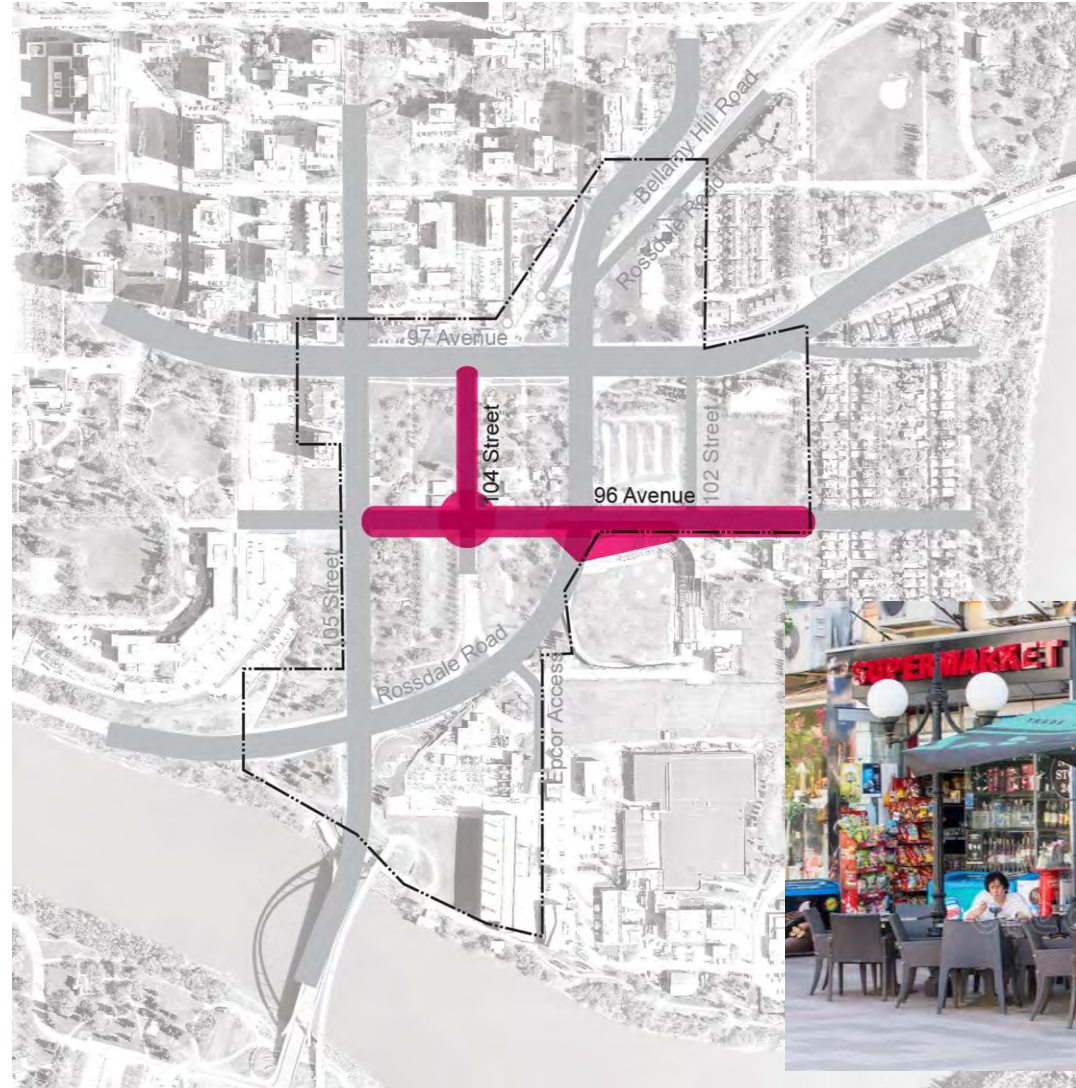

Rossdale Transportation Network

96 Avenue

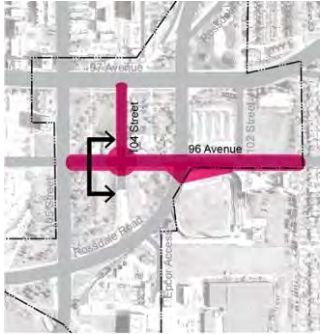

key plan



Rossdale Transportation Network

96 Avenue

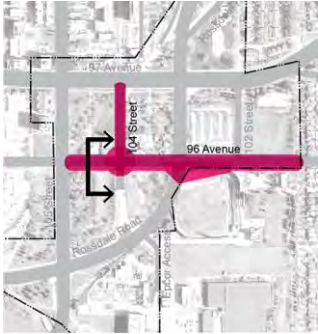

key plan

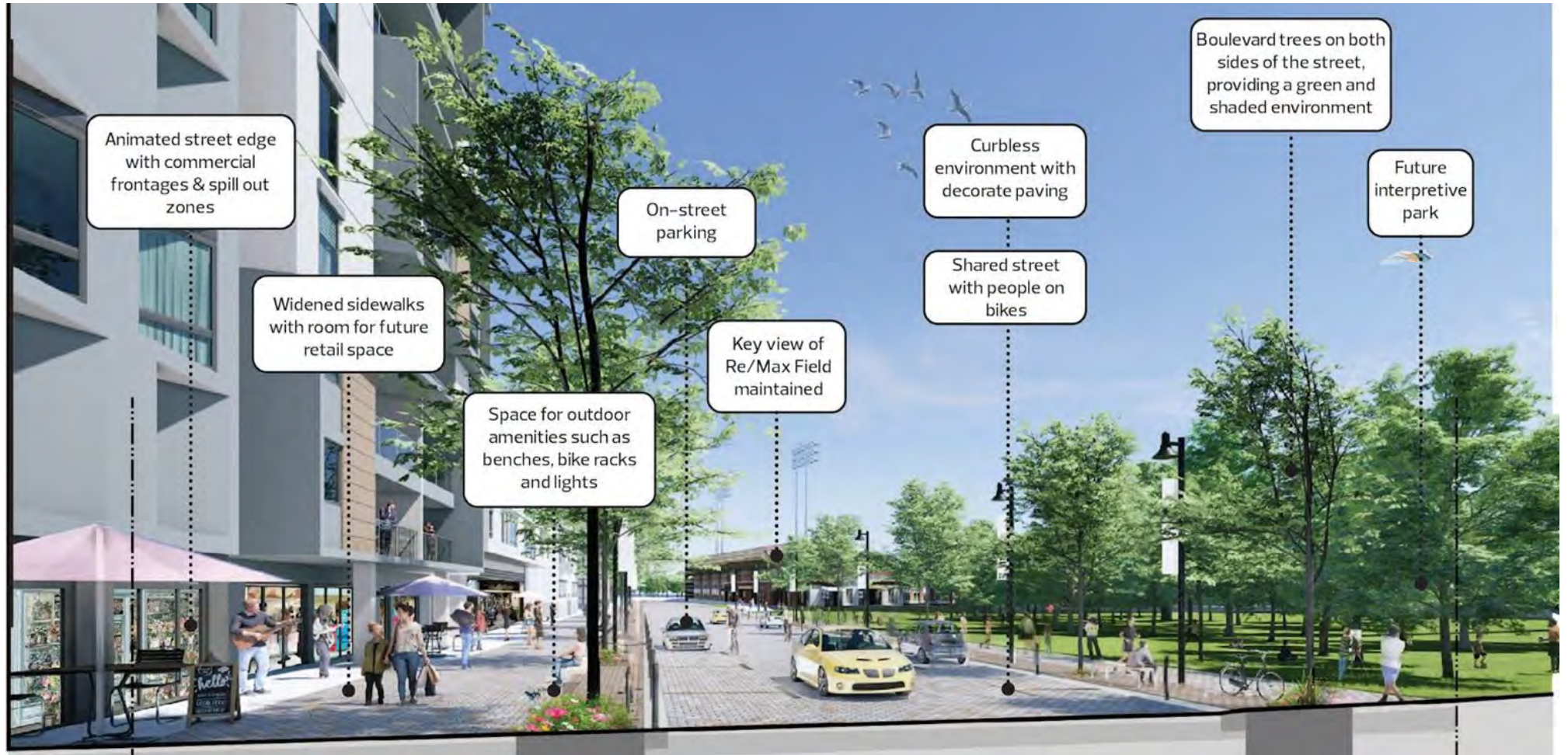

Rossdale Transportation Network

96 Avenue

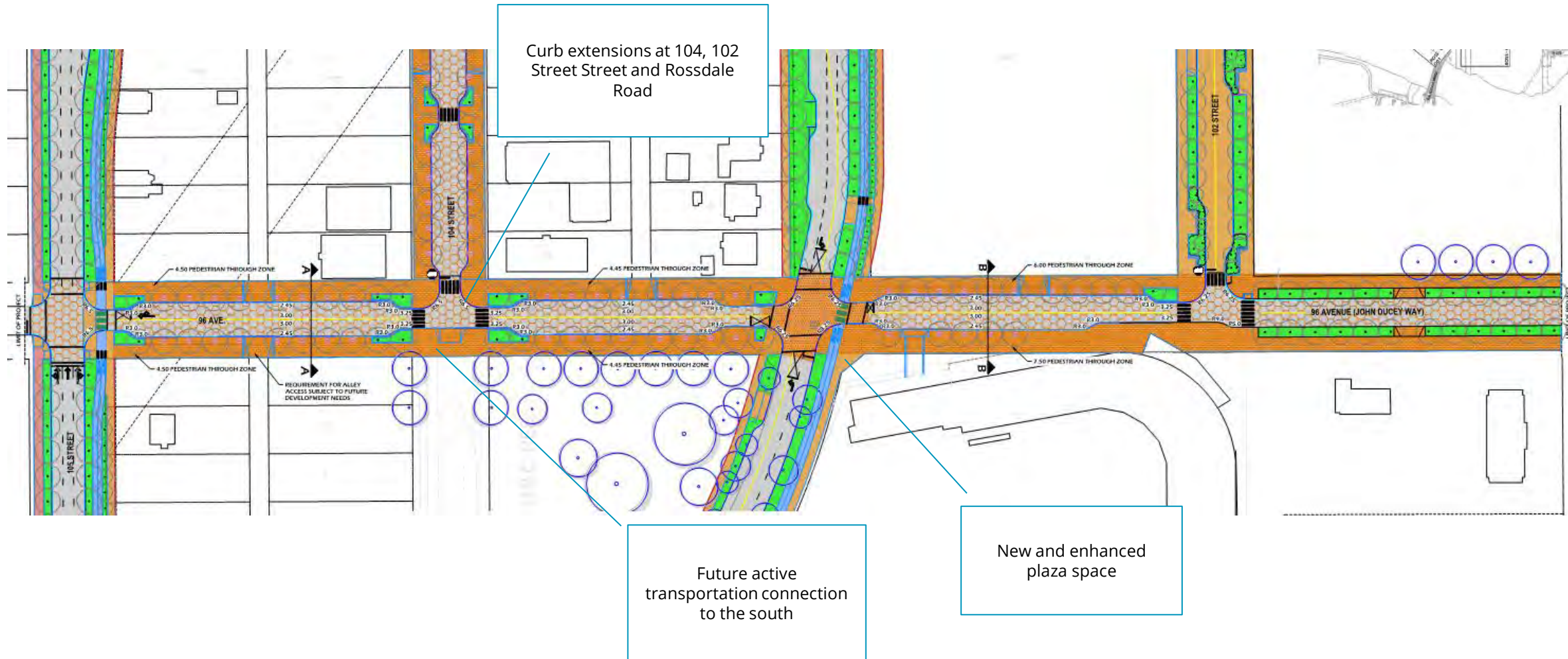

Rossdale Transportation Network

104 Street

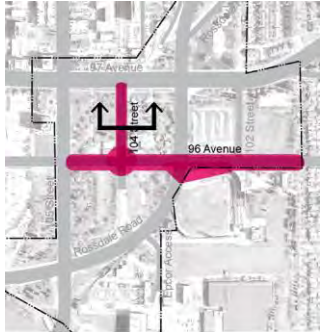

key plan



Rosssdale Transportation Network

104 Street

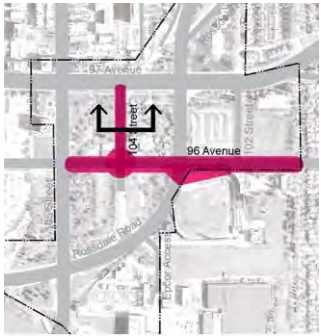

key plan



Rossdale Transportation Network

105 Street and 97 Avenue

3. Create Grand Boulevards

105 Street and 97 Avenue

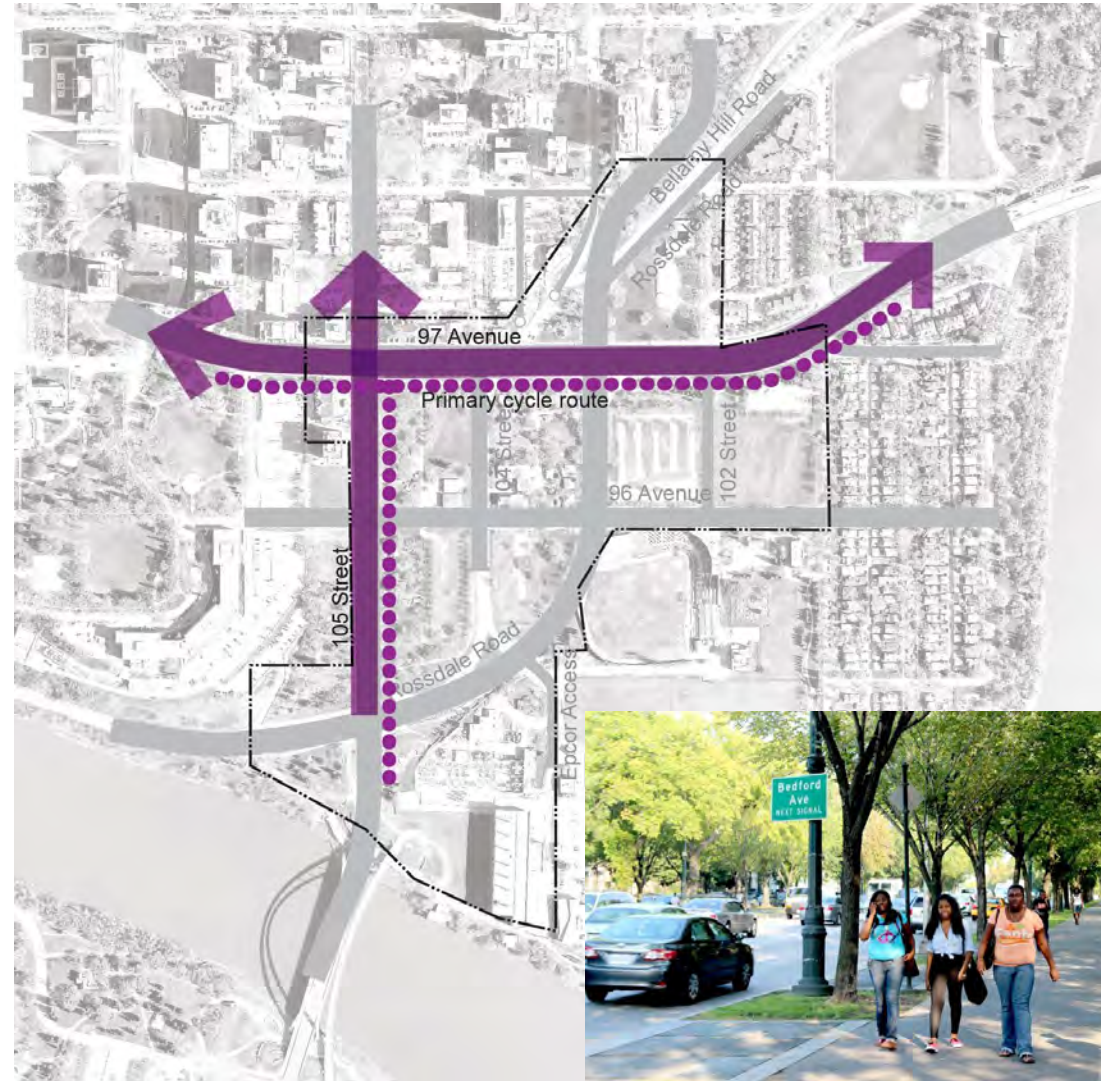

Rossdale Transportation Network

105 Street

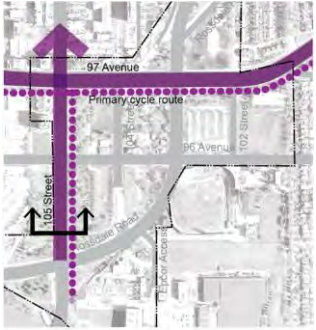

key plan



Rossdale Transportation Network

105 Street

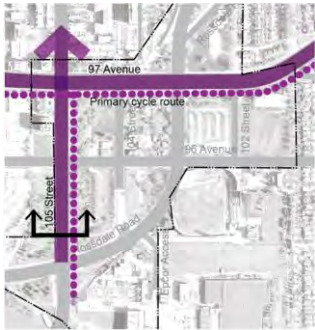

key plan

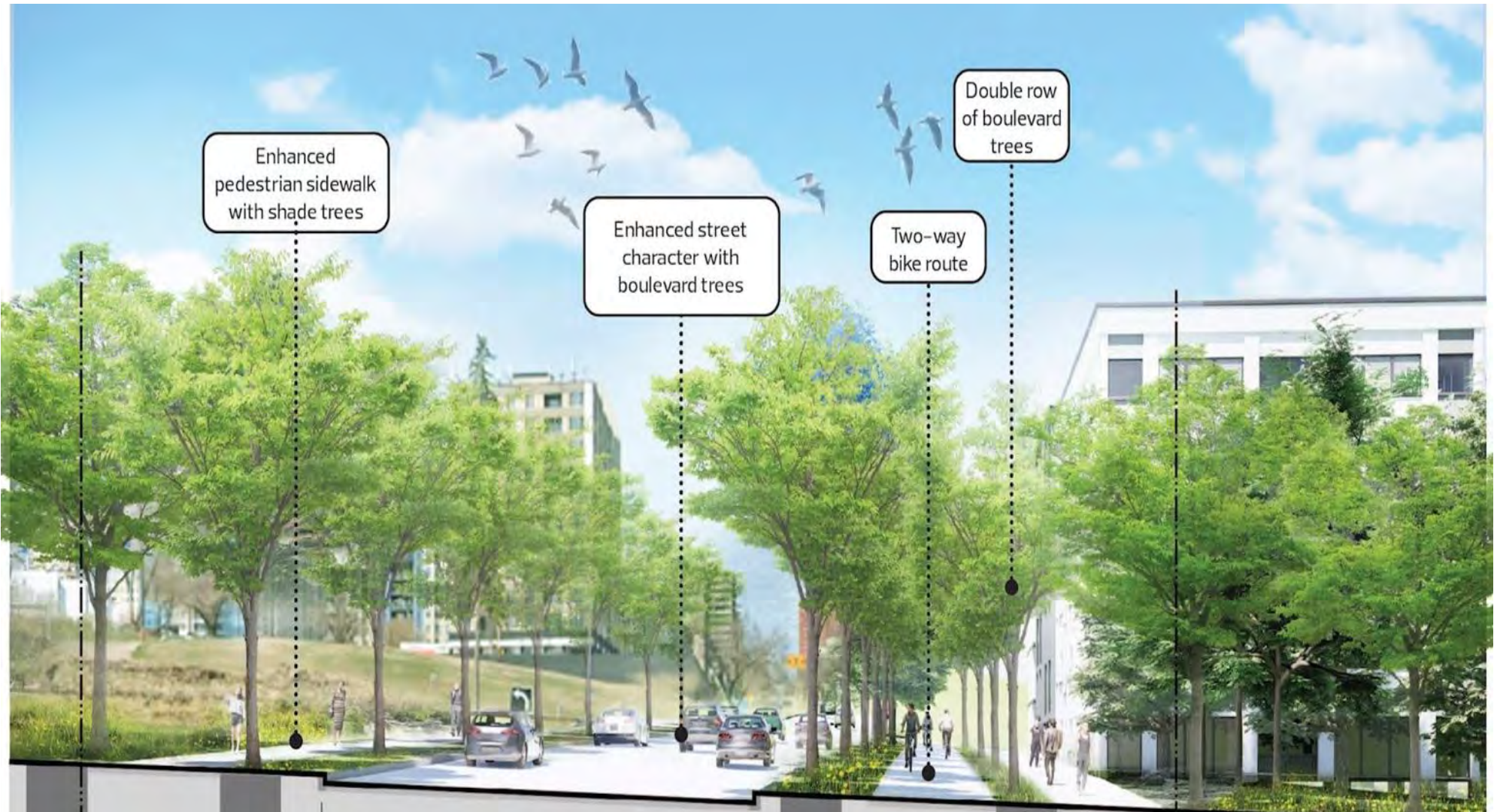

Rossdale Transportation Network

105 Street

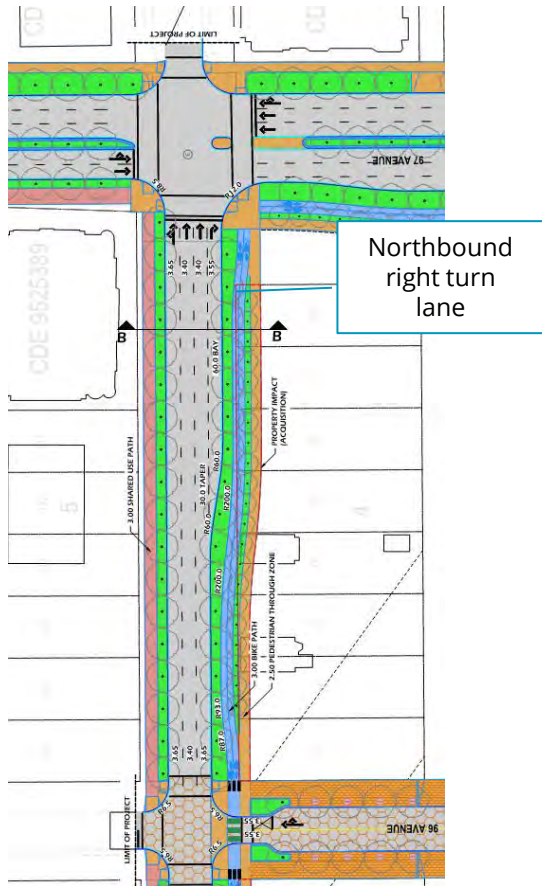

Enhanced crossing with pedestrian activated traffic signal

Repurpose Northbound lane to boulevard space

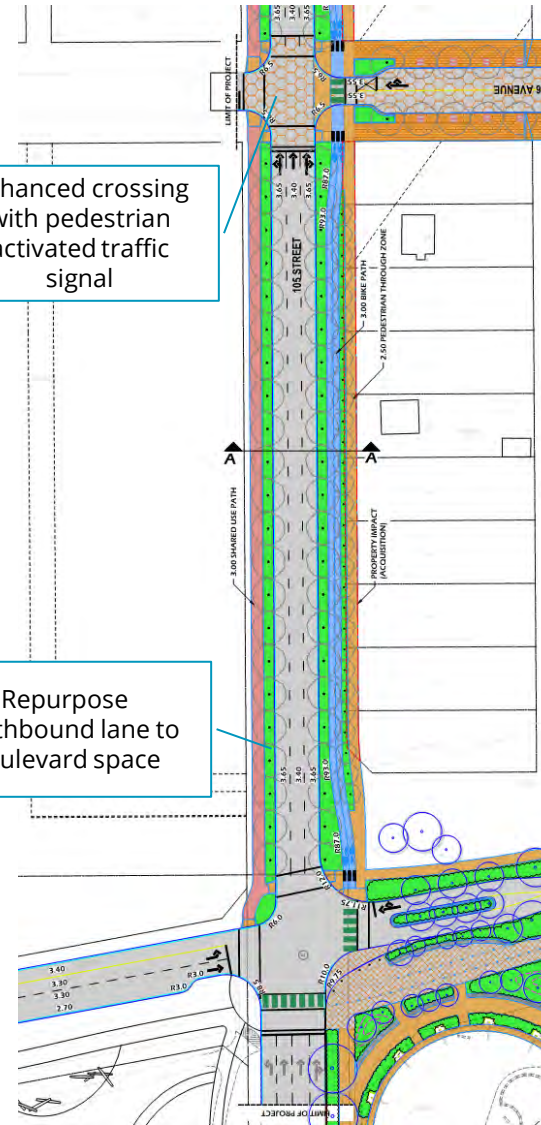

Rossdale Transportation Network

97 Avenue

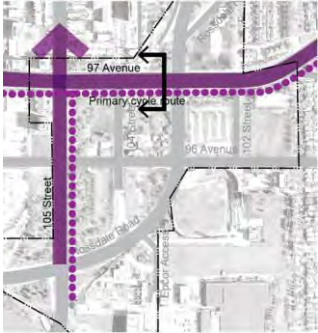

key plan

97 Avenue: Existing



Rossdale Transportation Network

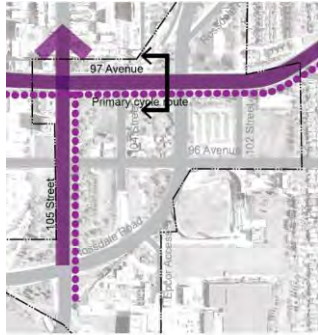

key plan

97 Avenue Proposed



Rossdale Transportation Network

105 Street

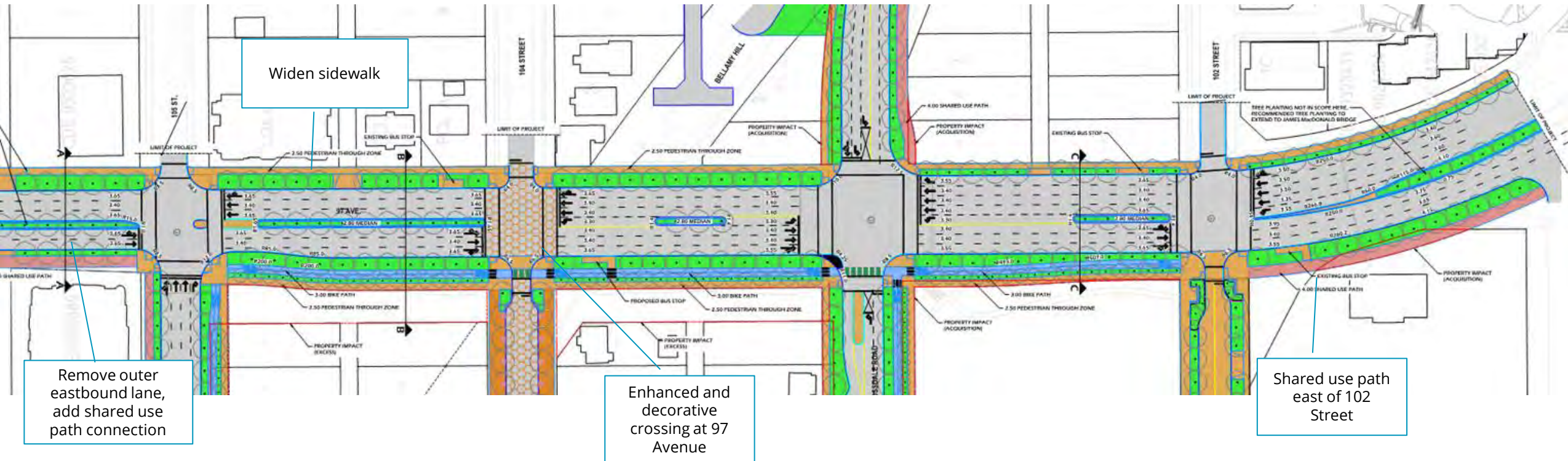

Rossdale Transportation Network

4. Enhanced Neighbourhood Connections

102 Street and Epcor Access



Rossdale Transportation Network

Epcor Access

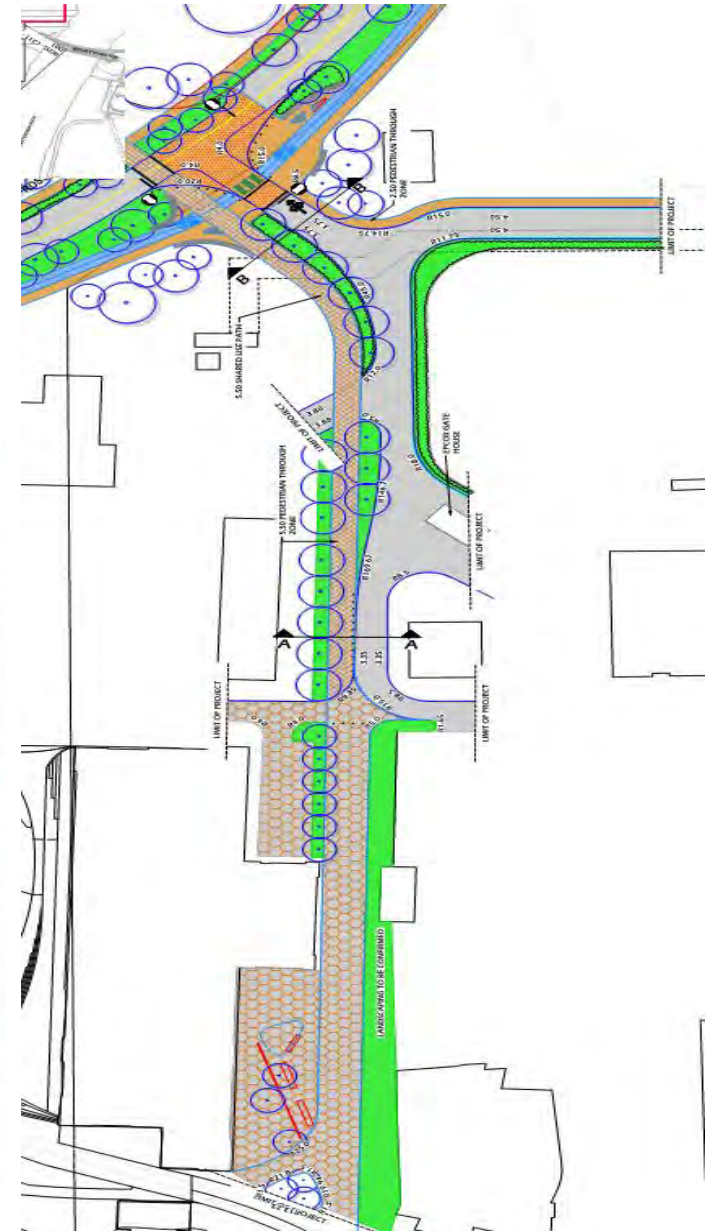
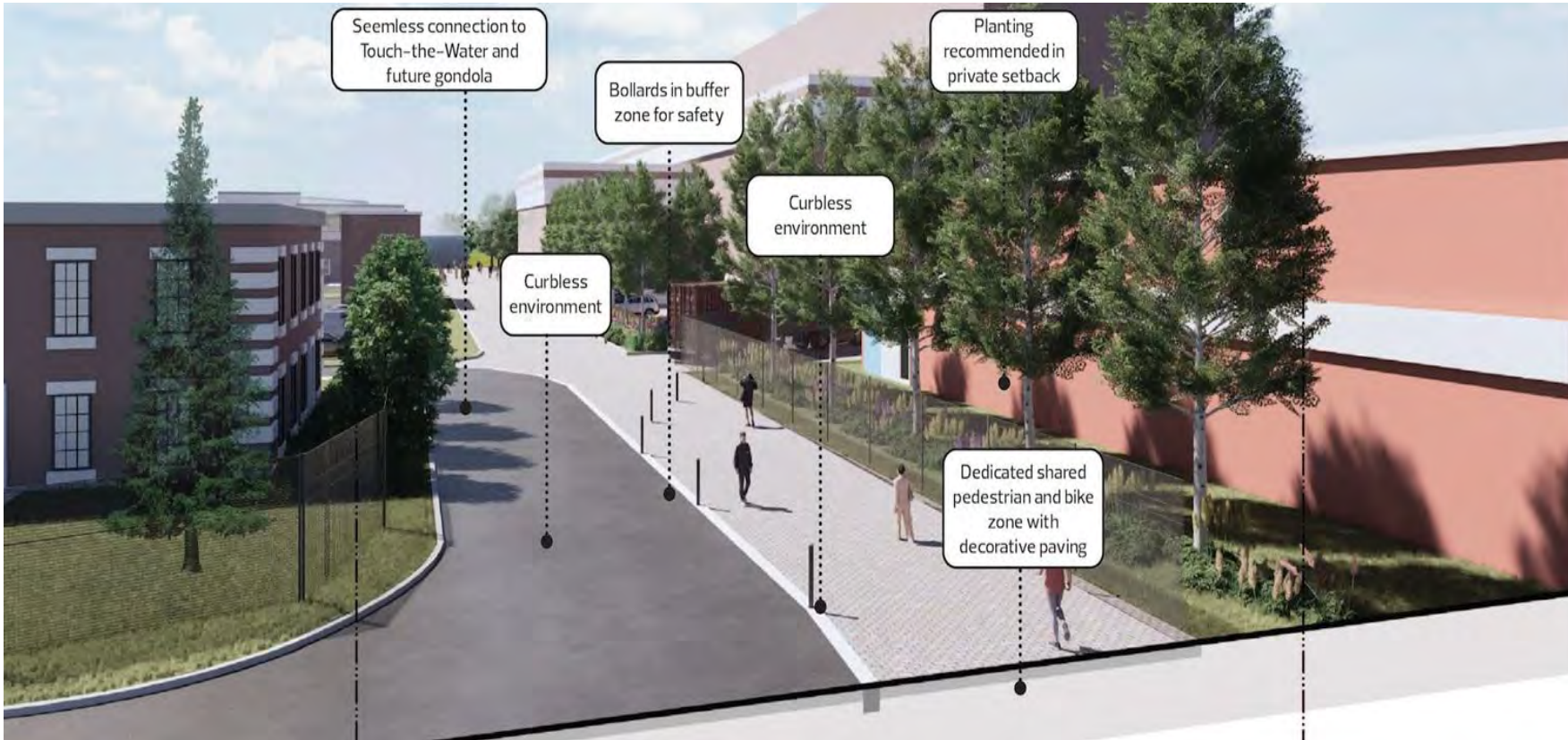

Rossdale Transportation Network

5. Simplify Connections North of 97 Avenue

Bellamy Hill Road and Rossdale Road North

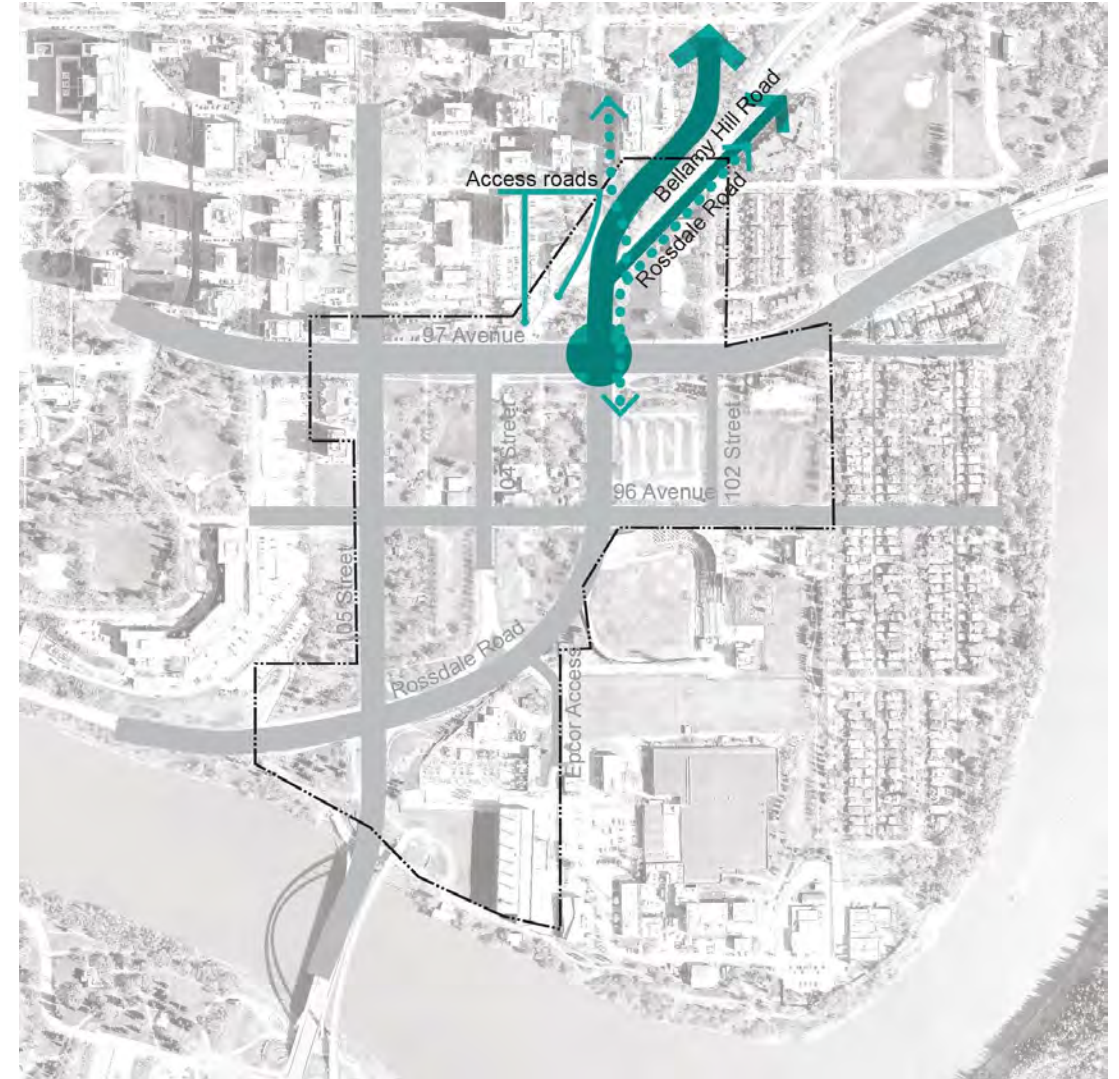

Rossdale Transportation Network

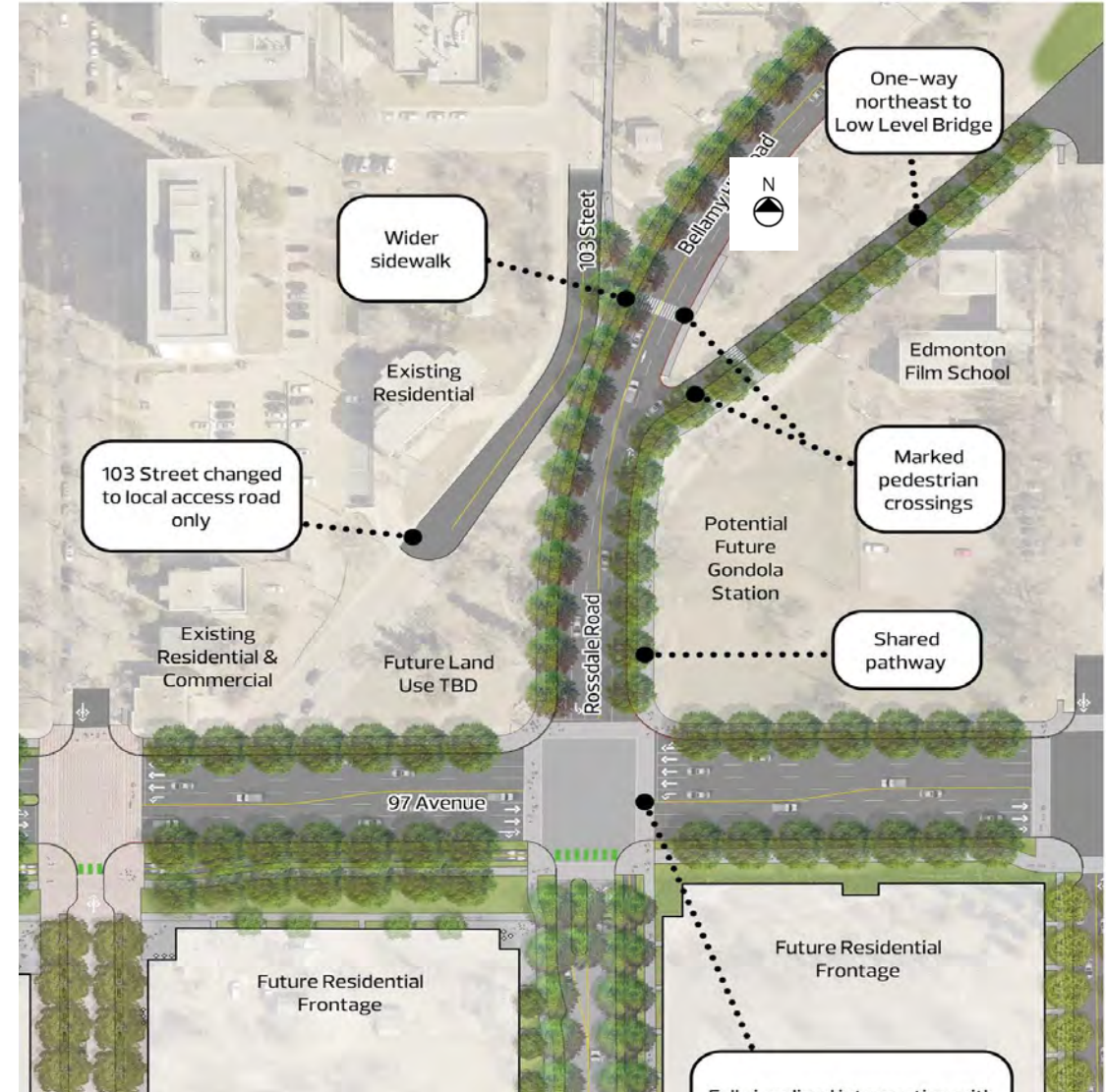

Rossdale Road Rehabilitation Project



- Add a shared use path
- Rossdale Road will be reduced from two lanes to one lane (north/east bound)
- An existing segment of Rossdale Road will be closed (south/west bound)
- New traffic signal at 99 Avenue and Bellamy Hill Road



Next Steps

- **Land Development and Transportation Implementation concurrently**
- **Rossdale Road Rehabilitation Reconstruction**
- **Secure the funding for Phase 1**
- **Planning and Design of Park and Power Plant**



Thank you

edmonton.ca/RossdaleTransportationNetwork